

USER INSTRUCTIONS

Car Alarm Immobiliser System

Thatcham M.I.R.R.C. Evaluation No:

TC2-1101/0200

COBRA
8185/6/8



IMPORTANT WARNING

The **Cobra 8185** Alarm Immobiliser is a Category 1 MIRRC Thatcham listed security system. If the installation of this product is modified or altered from the standard specifications, or non compliant accessories are fitted, the insurance approval will be invalidated.

User Instructions

Congratulations on purchasing a **Cobra 8185** Alarm System. It has been designed and manufactured to the highest standards utilising the latest S.M.D. technology for total reliability.

All round protection is ensured with:-

1. Passenger compartment protection using ultrasonic sensors or optional microwave sensors.
2. Multi-circuit engine immobilisation - operates immediately the system is armed, or passively 60 seconds after ignition is switched OFF and the driver's door opened, or 255 seconds after ignition OFF if the doors are not opened.
3. Peripheral protection to doors, boot and bonnet using direct contact switches.
4. Personal protection - remote control 'panic' button on radio keys.

Many of the security functions are integrated with your vehicle's electrical system and we recommend that you read the complete instruction booklet to ensure trouble free operation.

Also for your added safety, each system contains circuitry to ensure the alarm cannot be switched on when the vehicle's engine is running.

Your Cobra Dealer will be pleased to clarify any queries you may have with the system or its operation.

Even when using your Cobra 8185 Alarm System we would suggest the following additional precautions:-

- Avoid leaving valuable belongings in the car particularly if they are on view.
- Never leave Registration or Insurance Documents in the car.
- Never leave spare keys in the car.
- Always try to park in a well lit and safe area.

PIN Code

Each Cobra 8185 Alarm System has a unique PIN code which can be used for Emergency Disarm and is required, together with one of the emergency override touch keys, for programming replacement or additional radio keys.

Your PIN code is given on the card supplied with your Cobra 8185 Alarm System together with the serial number of the system itself. Please keep this card in a secure place - not in the car - and also make a note of these numbers for any second driver's use.

Without the PIN code and emergency override touch key no additional or replacement radio keys can be programmed into the system.

Radio Key Function	Button 'A'	Button 'B'
Arm	●	
Disarm	●	
Siren Interrupt	●	
Panic Alarm		●
Ultrasonic Sensor exclusion (within 20 seconds of arming)		●
Optional Microwave Sensor exclusion (press twice within 20 seconds of arming)		● x2

Radio Keys

The security system is operated by remote control radio keys. Two radio keys are supplied with each Cobra 8185 Alarm System. Always press the button for a full ONE SECOND to allow the whole code to be transmitted. The small LED on the radio key will flash whilst the button is held down. The Radio Keys should normally operate up to 5 metres from the car but range can be affected by other radio signals in the vicinity.

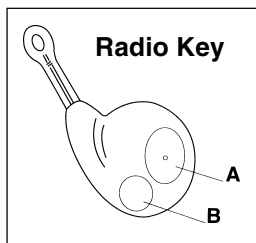

The Radio Keys are powered by a long life 3v Lithium battery (type CR2032 or equivalent). With normal usage a new battery should last between 3 and 5 years. Replacement batteries can be obtained from your Cobra Dealer.

Low Radio Key Battery Indication

If the small LED on the radio key flashes regularly or only once when the operating key is pressed, instead of flashing continuously, this indicates a low battery.

Battery Replacement

1. Open the case as shown in the diagram - levering the two sides apart in the area marked OPEN on the key case.
2. Remove the old battery as shown.

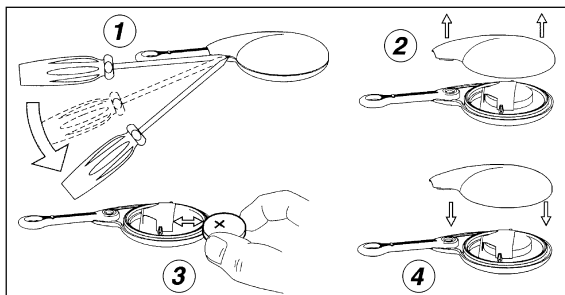

3. Wait for 10 seconds before inserting the new battery, ensuring the correct polarity (+ sign upwards) and holding the battery by the edge.
4. Close the case firmly making sure locating studs are correctly positioned to ensure a waterproof seal is made.
5. The remote key should now operate normally, but it may require re-synchronisation with the main control unit.

Testing the Remote Key & Re-synchronisation

If, at any time, the remote key does not operate the system, stand close to the car and press and hold down both buttons until the LED on the remote key goes out - approximately 10 seconds. Release both buttons - the LED will come on constantly. Then press button 'A' for approximately 1 second - the LED will flash - this should complete re-synchronisation.

In case of difficulties please consult your Cobra Dealer.

Passive Immobilisation

The System will automatically arm the double immobilisation 60 seconds after the ignition is switched OFF and the driver's door is opened. If the doors are not opened the delay is extended to 255 seconds after the ignition is switched OFF.

- The LED will flash.

It will not now be possible to start the engine, but in this instance the doors will not lock and the windows etc. will not close. The door trigger circuits and interior sensor do not arm.

DRIVING THE VEHICLE

To start the engine, ensure the ignition is switched OFF then disarm the immobiliser by pressing button 'A' on the radio key and then switch ON the engine within 255 seconds.

To fully arm the system after passive immobilisation, switch OFF the passive arming by pressing button 'A' on the radio key, then re-arm the system (as described in 'Arming the System').

Emergency Override Touch Key

The emergency override touch key can be used to disarm/de-immobilise your Cobra 8185 Alarm System in the event of lost or damaged radio keys. If your car is locked use your door key to enter the car and touch the Emergency Override Touch Key on the contacts of the touch receptacle - this will disarm and de-immobilise the security system. If the system was fully 'armed' the siren will sound until disarming has taken place. The car can then be started in the normal way.

- Up to four Emergency Override Touch Keys can be programmed into each Cobra 8185 Alarm System.

Additional/Replacement Radio Keys

The radio keys for your Cobra 8185 Alarm System have a 'protected self-learning' feature which allows up to **four** Radio Keys to be programmed into your system by using its unique PIN code in conjunction with the electronic touch keys.

All existing radio keys and touch keys must be re-programmed at the same time as any additional or replacement keys are being introduced to the system. Your Cobra Dealer will be able to carry out this procedure for you.

Arming the System

Radio Key - pressing the operating button 'A' will arm the system, indicated by:-

1. Two flashes of the vehicle's hazard lights.
 2. Continuous flashing of the LED warning light.
 3. Simultaneous locking of all doors.
- *Immediately the alarm unit is switched ON ('armed') the vehicle is immobilised.*

After switching ON ('armed') a period of approximately 45 seconds will elapse before the system is fully active. (This is a 'setting-up' and 'test period').

When the alarm is fully active it will be triggered by:-

1. Opening a door, boot or bonnet (Direct Contact Switches).
2. Movement within the vehicle (Ultrasonic or optional Microwave).
3. Turning on ignition.

When triggered the Electronic Siren will sound at 118dB and the hazard lights will flash for 30 seconds - at the end of this

period the system will close down and automatically re-set to provide protection against a further attempt by an intruder to enter the vehicle.

Disarming the System

On return to the vehicle, pressing operating button 'A' on the radio key will disarm the system. This is indicated by:-

1. One flash of the hazard warning lights.

Note: If the system has been triggered during your absence the hazard lights will flash 4 times and the buzzer will sound 4 times.

2. Extinguishing of the LED warning light - see note.

3. Unlocking of all doors.

Note: If the alarm has been triggered in your absence a 'status history' will be displayed by the LED warning light and is indicated as follows:-

★ Single pulse flashing of LED: One alarm state caused by opening of the boot, bonnet or doors.

★ 2 Twin pulse flashing of LED: One alarm state triggered by optional microwave sensor.

★ 3 Triple pulse flashing of LED: Alarm state triggered by the ultrasonic sensor or optional glass break.

★ 4 Quadruple flash repeated regularly: Alarm state caused by an attempt to start the car.

Note: This display can also show multiple triggering and other system diagnostics - please consult your Cobra dealer in case of any difficulties.

This display is extinguished when the ignition is turned on.

Siren Interrupt

Pressing button 'A' whilst the siren is sounding will turn the siren off. The Alarm System 'status' - i.e. 'armed' - will not be changed.

Panic Alarm/ Personal Protection

Pressing the auxiliary button 'B' will sound the siren for 15 seconds when the alarm system is in the 'armed' state.

Note: This function will not be operational during the 40 seconds set-up time required for the system to become fully active after it has been 'armed'.

Volumetric Protection Exclusion

Ultrasonic Sensor:

To arm the system without utilising the ultrasonic interior sensor, press the operating button 'A' in the normal way then, within 20 seconds, press the auxiliary button 'B'. This allows all other protection circuits to remain active whilst windows can be left partially open (for a dog inside the vehicle etc.). This command is indicated by a 'beep' from the siren.

Microwave Sensor:

To arm the system without utilising the microwave sensor, press the operating button 'A' in the normal way and press button 'B' twice within 20 seconds.

Illuminated Entry

On disarm the system will switch ON the courtesy light for 30 seconds, or until the ignition is switched ON.

Trouble Shooting

Your Cobra 8185 Alarm System has been installed by a fully trained technician. In the unlikely event of a problem occurring with it please contact your Cobra Dealer for assistance. If this is not immediately possible the following notes may be of help:-

Symptom: *Radio Key will not 'arm' or 'disarm' system.*

- The Radio Key battery may be flat (see notes on Low Battery Indication and Changing Battery).

Symptom: *The radio key may require re-synchronisation.*

- See Testing the Remote Key and Re-synchronisation section.

Symptom: *Alarm has triggered for no apparent reason.*

- When you 'disarm' the alarm the diagnostics code will be displayed by the LED warning light. If direct contact triggering is indicated then switches in doors, boot or bonnet may need adjusting - please consult your Dealer. If showing ultrasonic triggering please check that all windows, sunroof and air vents are closed and ensure that there are no loose moving objects (or animals) left in the vehicle. If the problem persists contact your Cobra Dealer for assistance.

Checking the Alarm System

You should check your Cobra 8185 Alarm System on a regular basis - once a week is recommended.

1. Direct Contact Check:

Arm the system and exclude the ultrasonic sensors - wait 45 seconds.

- Opening any of the vehicle doors, boot or bonnet will trigger the system and the siren will sound. Disarm the system from the radio key and repeat the process for each door, boot and bonnet.

2. Ultrasonic Sensor Check:

Whilst remaining seated in the car with doors and windows closed - Arm the system and wait 45 seconds.

- Rapid movement of your arms should trigger the system. Disarm in the normal way.

If at any time your alarm does not appear to be operating correctly please refer to the 'Trouble Shooting' section or, if in any doubt, contact your Cobra Dealer.